

- PROPOSED NEW TRAIL**
- WILL CREATE A TRAIL "LOOP"
 - WILL BE DESIGNED FOR SUSTAINABILITY (AVOID WET AREAS, FALL LINES AND STEEP SLOPES; INCLUDE ADEQUATE GRADE BREAKS TO SHEET WATER)

- MEADOW AREA**
- WILL BECOME CENTRAL LOCATION FOR VISITORS ENTERING THE PRESERVE
 - CLEAR AND GRUB INVASIVE PLANTS
 - WILL BECOME A MAINTAINED OPEN SPACE
 - A GATHERING LOCATION
 - PROVIDE KIOSK WITH EDUCATIONAL INFO AND PRESERVE MAP

- POND AREA**
- SEATING AREA
 - TRAIL ATOP BERM

CONNECTION TO PIKE COUNTY PARK VIA HUCKLEBERRY TRAIL

CONNECTION TO SAWKILL CREEK WATERFALL

- GENERAL PRESERVE NOTES**
- NO VEHICULAR ACCESS ON TRAIL
 - TRAIL WIDTH (5')
 - NO HUNTING
 - HIKERS ALLOWED
 - MOUNTAIN BIKES

- PROPOSED ENHANCEMENTS**
- ADD A FEW BENCHES ALONG TRAIL FOR REST AREAS
 - ADD INTERPRETIVE SIGNAGE
 - ADD DISTANCE MILE MARKERS

NORTHERN PORTION - 249.4 AC

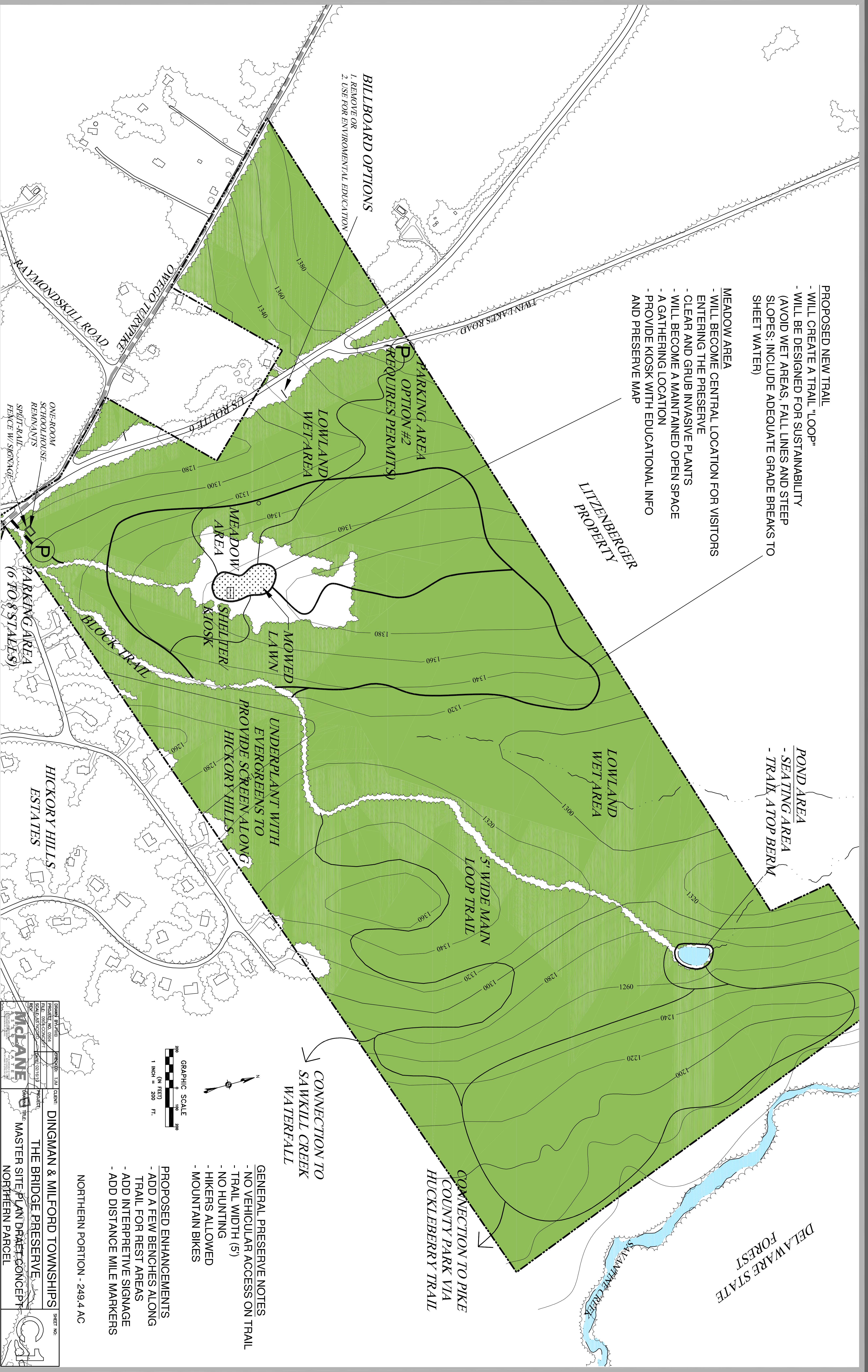

HICKORY HILLS ESTATES

PARKING AREA (6 V.O. & STALLS)

ONE-ROOM SCHOOLHOUSE REMNANTS
SPLIT-RAIL FENCE W/ SIGNAGE

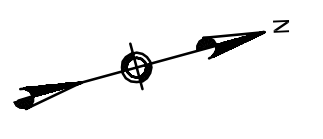
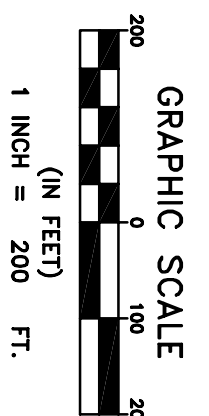

DRAWN BY: PJB	REVISIONS:	TITLE:	CIENT:
PROJECT NO.: 2012	DATE: 02/16/12	PROJECT:	DINGMAN & MILFORD TOWNSHIPS
SCALE AS SHOWN	DATE: 02/16/12	PROJECT:	THE BRIDGE PRESERVE
REV:		PROJECT:	MASTER SITE PLAN DRAFT CONCEPT
		PROJECT:	NORTHERN PARCEL
		SHEET NO.:	1